



Fisher Traditional fires have been warming New Zealand homes for decades. Originally from Canada, the proven design features remain unchanged and will fit any décor.

- Heavy gauge steel construction and fire brick linings for safety and long life
- Two step top that has been engineered for efficiency and offers the bonus of a multi-level cook top
- Quick action door latches and single fingertip air control for easy operation
- Special air flow system that washes unwanted smoke from the glass door and helps prevent soot build-up
- Ash shelf to catch hot embers
- Water heating option available



## *Hammer*

- Clean air wood burning fire
- Approximate heating area: 160–225m<sup>2</sup>
- Estimated peak heat output: 25kW
- Emissions: 0.83g/kg dry / 0.92g/kg with 2kW water booster
- Efficiency: 74% dry / 69% with 2kW water booster
- Max log length: 500mm
- NES\* and ECan\*\* approved
- 10 year firebox warranty



## *Denniston*

- Multi-fuel fire (wood and coal burning)
- Approximate heating area: 225m<sup>2</sup>
- Estimated peak heat output: 24kW
- Removable ash tray
- Optional water heating: up to 5.6kW
- Max log length: 460mm
- NES\* exempt
- 5 year firebox warranty

Flue size for all Fisher fires is 150mm

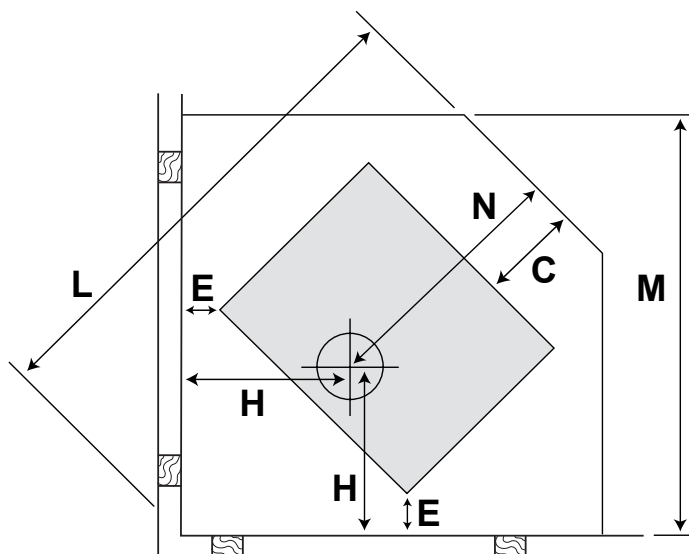
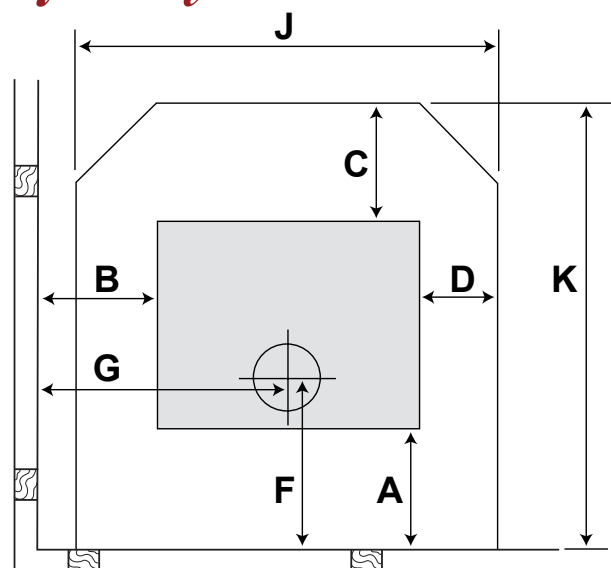

combustible wall      combustible wall

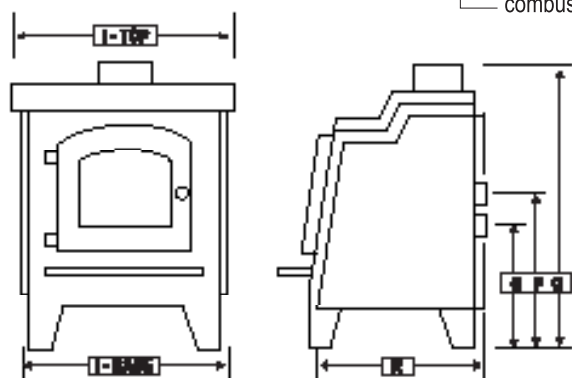

DENNISTON

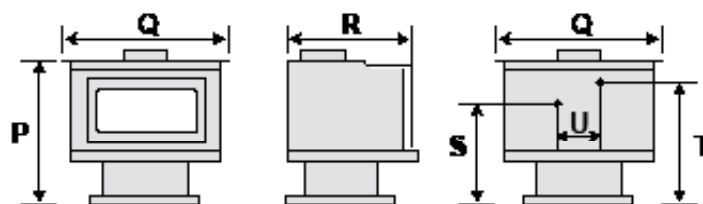

HANMER

	A	B	C*	D	E	F	G	H	J	K	L	M	N	I (top)	I (base)	O	P	Q	R
DENNISTON – Multi-Fuel																			
Fisher Heat Shield & Single S/S Flue Screen	220	470	300	107	250	379	763	544	800	1064	1453	1162	685	586	563	496	516	794	544
														P	Q	R	S	T	U
HANMER – Clean Air																			
with Fisher Flue Kit MKII	100	250	300	120	100	233	680	498	1100	988	1460	1298	756	840	860	738	663	694	254

\* Dimension 'C' is taken from firebox door seal lip to the front of the floor protector

Floor protector requirements: Insulated – Denniston. Non-Insulated – Hanmer.

**Your Fisher stockist:**



RETAIL LINKS  
LIMITED™



**NZHHA**  
New Zealand Home Heating Association Inc.